

Napkin Folding

Below are a few easy to follow Napkin fold designs to add that finishing touch to your table.

The Arum Lily

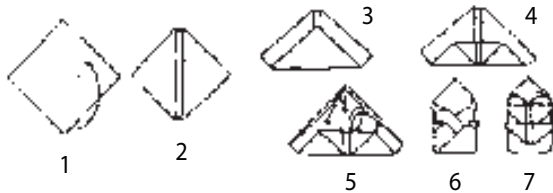

1. Fold napkin bringing bottom up to top.
2. Fold corners to top.
3. Fold bottom point up to 1" below top.
4. Fold point back onto itself.
5. Fold each of points at top down and tuck under edge of folded-up bottom and fold down one layer of top point and tuck under base.
6. Turn napkin over and tuck left and right sides into each other.
7. Open base and stand.

Bird of Paradise

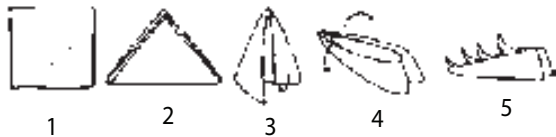

1. Fold the napkin in half and in half again.
2. Fold in half diagonally with points on the top and facing up.
3. Fold left and right sides down along center line, turning their extended points under.
4. Fold in half on long dimension with edges facing out.
5. Pull up points and arrange on a fabric surface.

Bishop's Mitre

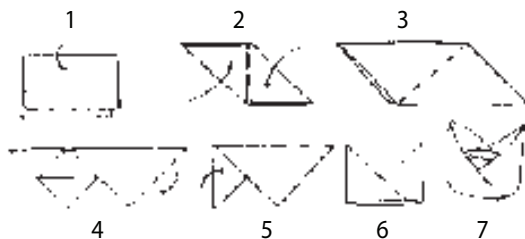

1. Fold napkin bringing top to bottom.
2. Fold corners to center line.
3. Turn napkin over and rotate $\frac{1}{4}$ turn.
4. Fold bottom edge up to top edge and flip point out from under top fold.
5. Turn left end into pleat at left forming a point on left side.
6. Turn napkin over and turn right end into pleat forming a point on right side.
7. Open base and stand upright.

The Candle

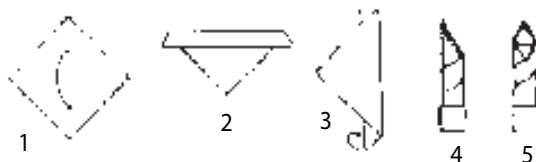

1. Fold the napkin in half diagonally.
2. Fold down the base $\frac{1}{3}$ of the way.
3. Turn napkin over and roll from the bottom to top.
4. Tuck corners inside cuff at base of fold and stand.
5. Turn one layer of the point down and set on base.

The Cardinal's Hat

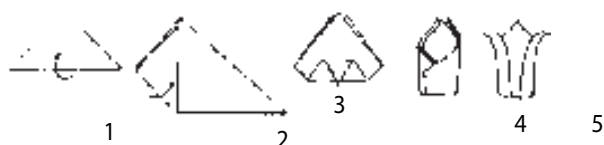

1. Fold napkin in half diagonally.
2. Fold corners to meet at top point.
3. Turn napkin over with points to the top, fold lower corner and fold bottom $\frac{2}{3}$ way up.
4. Fold back onto itself.
5. Bring corners together tucking one into the other. Open base of fold and stand upright.